



655 Eisenhower Drive  
Owatonna, MN 55060 USA  
Phone: (507) 455-7000  
Tech. Serv.: (800) 533-6127  
Fax: (800) 955-8329  
Order Entry: (800) 533-6127  
Fax: (800) 283-8665  
International Sales: (507) 455-7223  
Fax: (507) 455-7063

Form No. 100734

Parts List for:

1823  
1823A  
309110

## Bottle Jack Press

Maximum Capacity: 12 Tons

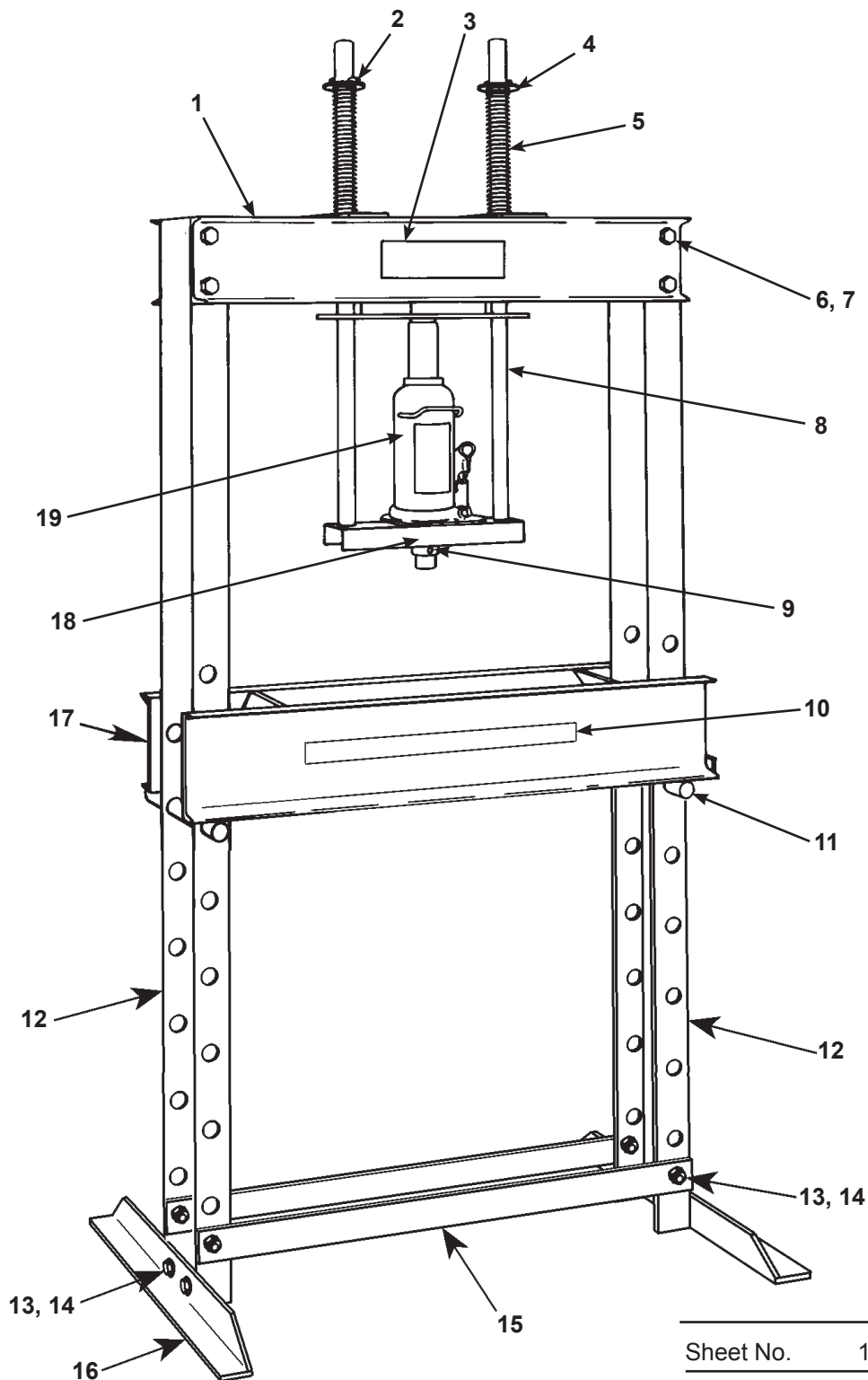

Sheet No. 1 of 1

Issue Date: Rev. D, June 24, 2014

Item No.	Part No.	No. Req'd	Description
-	<b>309110</b>	1	12-Ton Press Frame (Frame assembly only. Includes items 1 through 18. Does not include item 19.)
1	<b>61994</b>	1	Upper Bolster
2	<b>14152</b>	2	Roll Pin (5/16 dia. x 3" Lg.)
3	<b>309091</b>	1	Trade Name & Capacity Decal
4	<b>215422</b>	2	Washer
5	<b>215421</b>	2	Spring
6	<b>10096</b>	8	Cap Screw (5/8-11 x 1-1/4" Lg.)
7	<b>10214</b>	8	Nut (5/8-11)
8	<b>61990</b>	1	Pressing Bracket
9	<b>10136</b>	1	Set Screw (1/4-20 x 1/4" Lg.)
10	<b>46895</b>	1	Warning Decal
11	<b>309083</b>	2	Bolster Pin
12	<b>61997</b>	2	Upright
13	<b>10080</b>	8	Cap Screw (1/2-13 x 1-1/4" Lg.)
14	<b>10208</b>	8	Nut (1/2-13)
15	<b>309115</b>	2	Strap
16	<b>309084</b>	2	Foot
17	<b>61991</b>	1	Lower Bolster
18	<b>215423</b>	1	Pressing Pin
19	<b>5213</b>	1	Bottle Jack (used on 1823 and 1823A)

Refer to any operating instructions included with the product for detailed information about operation, testing, disassembly, reassembly, and preventive maintenance.

Items found in this parts list have been carefully tested and selected by OTC. **Therefore: Use only OTC replacement parts!**

Additional questions can be directed to the OTC Technical Services Department.