



655 Eisenhower Drive
Owatonna MN 55060 USA
Phone: (507) 455-7000
Tech. Serv.: (800) 533-6127
Fax: (800) 955-8329
Order Entry: (800) 533-6127
Fax: (800) 283-8665

Form No. 106166

Instructions
for:

7937

GM Oil Cooler Line Disconnect Tool

Application: 1991 - current 2WD or 4WD pickups and vans with 4L80E transmissions
1993 - current 2WD or 4WD pickups and vans with 4L60E transmissions

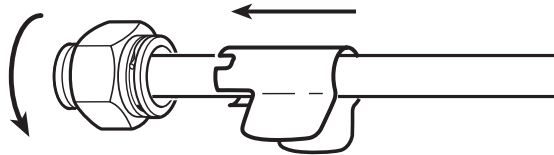

1. Remove the retaining clips from the oil cooler lines. Slide protective caps away from the fitting.
2. Snap the disconnect tool (No. 7937) on the line with the slots facing the fitting as shown.
3. Pinch the tool's ears together until the tool slides into the fitting I.D. Rotate the tool until you feel the ears on the clip slide into the slots on the tool.
4. Turn the tool in either direction until the tangs force the clip open; pull the line out of the fitting.
5. Repeat steps 2 – 4 for second oil cooler line.

© Bosch Automotive Service Solutions

Sheet 1 of 1
Rev. C September 29, 2014



655 Eisenhower Drive
Owatonna MN 55060 USA
Phone: (507) 455-7000
Tech. Serv.: (800) 533-6127
Fax: (800) 955-8329
Order Entry: (800) 533-6127
Fax: (800) 283-8665

Form No. 106166

Instructions
for:

7937

GM Oil Cooler Line Disconnect Tool

Application: 1991 - current 2WD or 4WD pickups and vans with 4L80E transmissions
1993 - current 2WD or 4WD pickups and vans with 4L60E transmissions

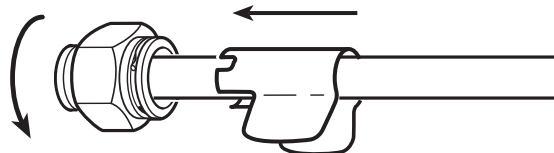
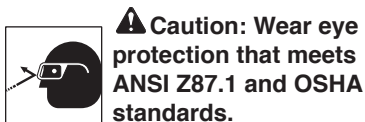

1. Remove the retaining clips from the oil cooler lines. Slide protective caps away from the fitting.
2. Snap the disconnect tool (No. 7937) on the line with the slots facing the fitting as shown.
3. Pinch the tool's ears together until the tool slides into the fitting I.D. Rotate the tool until you feel the ears on the clip slide into the slots on the tool.
4. Turn the tool in either direction until the tangs force the clip open; pull the line out of the fitting.
5. Repeat steps 2 – 4 for second oil cooler line.

© Bosch Automotive Service Solutions

Sheet 1 of 1
Rev. C September 29, 2014