



655 Eisenhower Drive  
Owatonna, MN 55060 USA  
Phone: (507) 455-7000  
Tech. Serv.: (800) 533-6127  
Fax: (800) 955-8329  
Order Entry: (800) 533-6127  
Fax: (800) 283-8665  
International Sales: (507) 455-7223  
Fax: (507) 455-7063

Form No. 106210

Operating Instructions  
for:

6024

## Ford Crankshaft Positioning Tool

Applications: 1993 & newer 4.2L, 4.6L two valve; 4.6L four valve; and 5.4L and 6.8L V-8 engines

**⚠ CAUTION:** To prevent damage to valves and pistons, **DO NOT** rotate the crankshaft and/or camshaft(s) when removing the timing chain(s) and installing the cylinder heads. Because this is not a free-wheeling engine, if it has "jumped time" there will be damage to the valves and/or pistons, which will require the removal of the cylinder heads.

1. Install crankshaft positioning tool No. 6024 (same as Ford No. 303-448) over crankshaft and engine front cover alignment dowel. This will position the crankshaft at top dead center for correct timing chain installation.

Install tool over front cover alignment dowel.

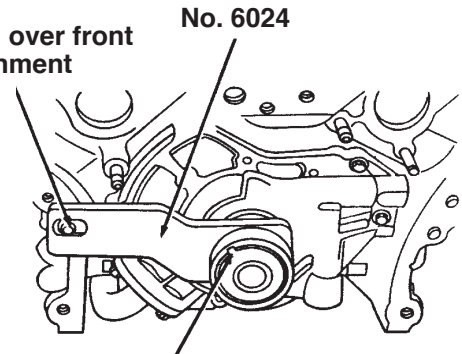

Align crankshaft woodruff key with keyway on tool.

© Bosch Automotive Service Solutions LLC

Rev B, August 7, 2014



655 Eisenhower Drive  
Owatonna, MN 55060 USA  
Phone: (507) 455-7000  
Tech. Serv.: (800) 533-6127  
Fax: (800) 955-8329  
Order Entry: (800) 533-6127  
Fax: (800) 283-8665  
International Sales: (507) 455-7223  
Fax: (507) 455-7063

Form No. 106210

Operating Instructions  
for:

6024

## Ford Crankshaft Positioning Tool

Applications: 1993 & newer 4.2L, 4.6L two valve; 4.6L four valve; and 5.4L and 6.8L V-8 engines

**⚠ CAUTION:** To prevent damage to valves and pistons, **DO NOT** rotate the crankshaft and/or camshaft(s) when removing the timing chain(s) and installing the cylinder heads. Because this is not a free-wheeling engine, if it has "jumped time" there will be damage to the valves and/or pistons, which will require the removal of the cylinder heads.

1. Install crankshaft positioning tool No. 6024 (same as Ford No. 303-448) over crankshaft and engine front cover alignment dowel. This will position the crankshaft at top dead center for correct timing chain installation.

Install tool over front cover alignment dowel.

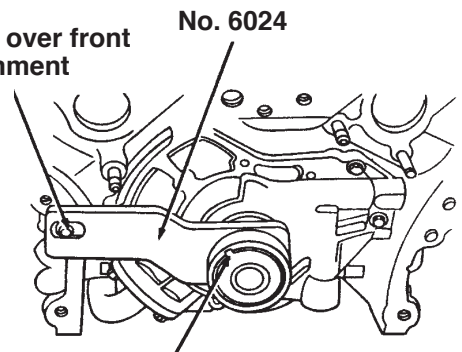

Align crankshaft woodruff key with keyway on tool.

© Bosch Automotive Service Solutions LLC

Rev B, August 7, 2014