

SPILL-FREE TRANSMISSION FLUID FILLS

- ✓ DESIGNED FOR UNDERCAR
TRANSMISSION FLUID SERVICE
- ✓ LIFETIME WARRANTY

TRANSMISSION FLUID FILL/ EXTRACT KIT WITH ADAPTERS

- 6L (1.5 gallons) reservoir bottle permanently sealed for safety
- Powered by shop air supply with a PSI safety relief valve
- Press-on quick connection for one-hand setup
- Universal adapter plus 14 OE-style adapters
- Extract from bulk ATF containers - dispense through transmission fill port
- Includes the 6792-EDB Extraction Dispenser Bottle and 6792-TFA Transmission Fluid Adapter (14 piece "OE style" ATF adapters)



6792-EDB TRANSMISSION FLUID RESERVOIR

- A sturdy, sealed 6.0L (1.5 Gal) reservoir and common adapter hoses designed to handle transmission fluid.
- A single valve controls fluid flow to extract or dispense transmission fluid.
- The universal adapter accommodates most domestic vehicles with filling ports located on transmission side walls.
- Locking handle for convenience and pressure relief valve for safety.



Includes:

- Universal transmission adapter hose (27" OAL) including coupling nipple
- Transmission fluid extraction tube (38" OAL) including coupling nipple
- Transmission fluid dispensing hose (80" OAL) including coupling nipple and trigger nozzle

6792-TFA TRANSMISSION FILLING ADAPTERS

- 14-piece OE style transmission adapters
- Easy push-on coupler design
- Adapter chart for application information
- Convenient storage case with molded part reference number



Description	Application
Adapter M10x1	Audi, Mini Cooper, Volkswagen
Adapter 1/8"-27	Ford
Adapter	Audi, Skoda, Volkswagen
Adapter	Audi, Porsche, Volkswagen
Adapter Universal	BMW, Honda, Nissan
Adapter M12x1.5	Altis, Mercedes-Benz
Adapter M22x1.5	Audi, Volkswagen, CVT
Adapter M24x1.5	Audi, Volkswagen, DSG
Adapter M30x1.5	Audi, Skoda, Volkswagen
Adapter 5/16"-24UNF	Volvo
Adapter M18x1.5	Lexus, Toyota
Adapter M18x1.5	Skoda, Volkswagen
Universal Flexible Hose 300mm	Honda, Hyundai, Kia
Adapter M8x1	Infiniti, Nissan

Filling The Bottle

- 1 - Connect hose with trigger and extraction hose to quick connect on the bottle.
- 2 - Set shop air pressure to 90 PSI, and connect to the bottle.
- 3 - Turn the Extract/Dispense valve knob in the Extract direction until it stops.
- 4 - Turn the inlet valve lever to Extract mode.
- 5 - Place end of extraction hose into container of recommended transmission fluid.
- 6 - Press and hold (or lock in hold position with clip) the handle lever.
- 7 - Press hose trigger to transfer fluid from container into the bottle.

ALWAYS wear approved eye protection.

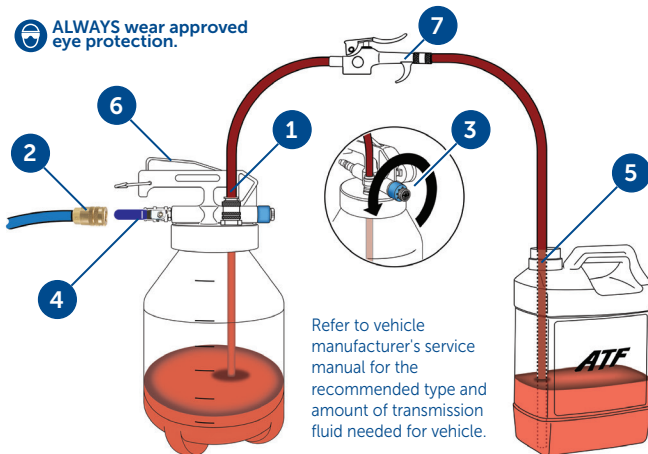

Refer to vehicle manufacturer's service manual for the recommended type and amount of transmission fluid needed for vehicle.

Filling Vehicle Transmission

- 1 - Connect hose with trigger to quick connect on the bottle.
- 2 - Connect trigger and appropriate adapter to vehicle transmission.
- 3 - Set shop air pressure to 90 PSI, and connect to bottle.
- 4 - Turn the Extract/Dispense valve knob in the Dispense direction until it stops.
- 5 - Turn the inlet valve lever to Dispense mode.
- 6 - Press and hold (or lock in hold position with clip) the handle lever.
- 7 - Press hose trigger to transfer fluid from the bottle into vehicle transmission.

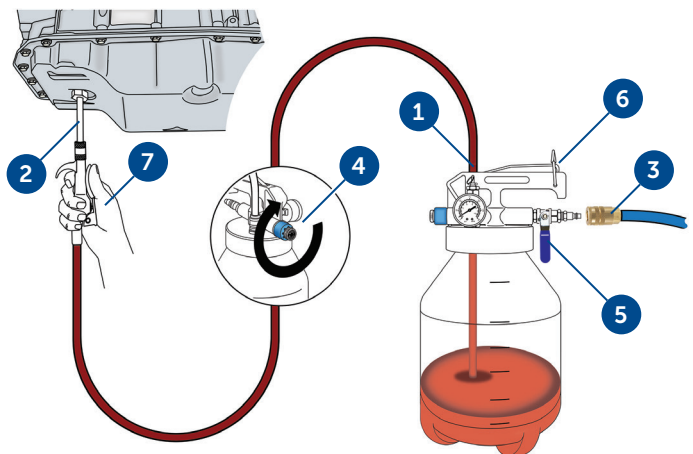

Refer to the application guide in Adapter Kit and choose an adapter as needed to fill the vehicle's transmission.