



655 Eisenhower Drive
Owatonna, MN 55060 USA
Phone: (507) 455-7000
Tech. Serv.: (800) 533-6127
Fax: (800) 955-8329
Order Entry: (800) 533-6127
Fax: (800) 283-8665
International Sales: (507) 455-7223
Fax: (507) 455-7063

Form No. 520112

Operating Instructions
for:

6583

StrutTamer Bridge Accessory

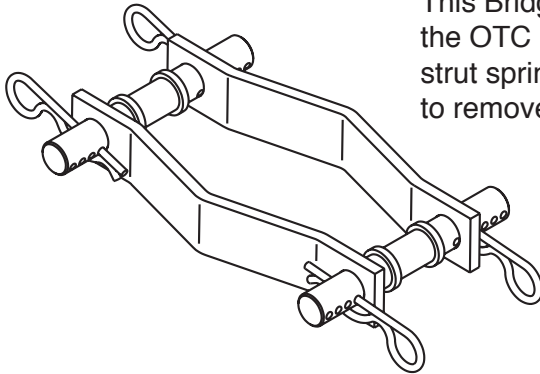

This Bridge Accessory (No. 6583) is used with the OTC StrutTamer (No. 6580) on MacPherson strut springs that cannot be compressed enough to remove the retaining nut.

Safety Precautions



WARNING: Spring compression creates a potentially dangerous situation because of the energy trapped between the spring mounts. To prevent personal injury:

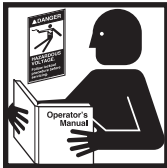

- Read, understand, and follow all operating instructions and safety precautions included with the tools. If the operator cannot read these instructions, operating instructions and safety precautions must be read and discussed in the operator's native language.

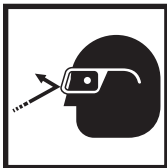

- Wear eye protection that meets ANSI Z87.1 and OSHA requirements when using the StrutTamer and bridge accessory.

- Use these tools on MacPherson struts only.

- Check the condition of the StrutTamer and bridge accessory before each use; do not use the tools if they are in poor condition.

- Before compressing a spring, fully engage the top hooks of the StrutTamer to the adjusting pins on the bridge accessory.

- Compress the spring only until it is loose in its spring mounts. Compressing the spring too far will cause premature tool failure that can result in severe personal injury.
- Do not remove the piston rod nut until the spring is compressed enough to be loose in the spring mount.

Sheet No. 1 of 1

Issue Date: Rev. B, August 12, 2014

1. Refer to the vehicle service manual, and follow the manufacturer's recommended procedure to remove the strut assembly from the vehicle.
2. Refer to the StrutTamer instructions to load the strut assembly into the StrutTamer.
3. Assemble the bridge on the top plate as shown. (Do NOT use the bridge on the bottom plate.)
 - Place the straps as close as possible around the bearing housing in the strut assembly top plate.
 - Install the hairpins on the adjusting pins.
 - The assembled bridge must have solid contact with the top plate.
4. Clamp the StrutTamer's locking jaws around the bridge's adjusting pins, between the shoulders on the pins.

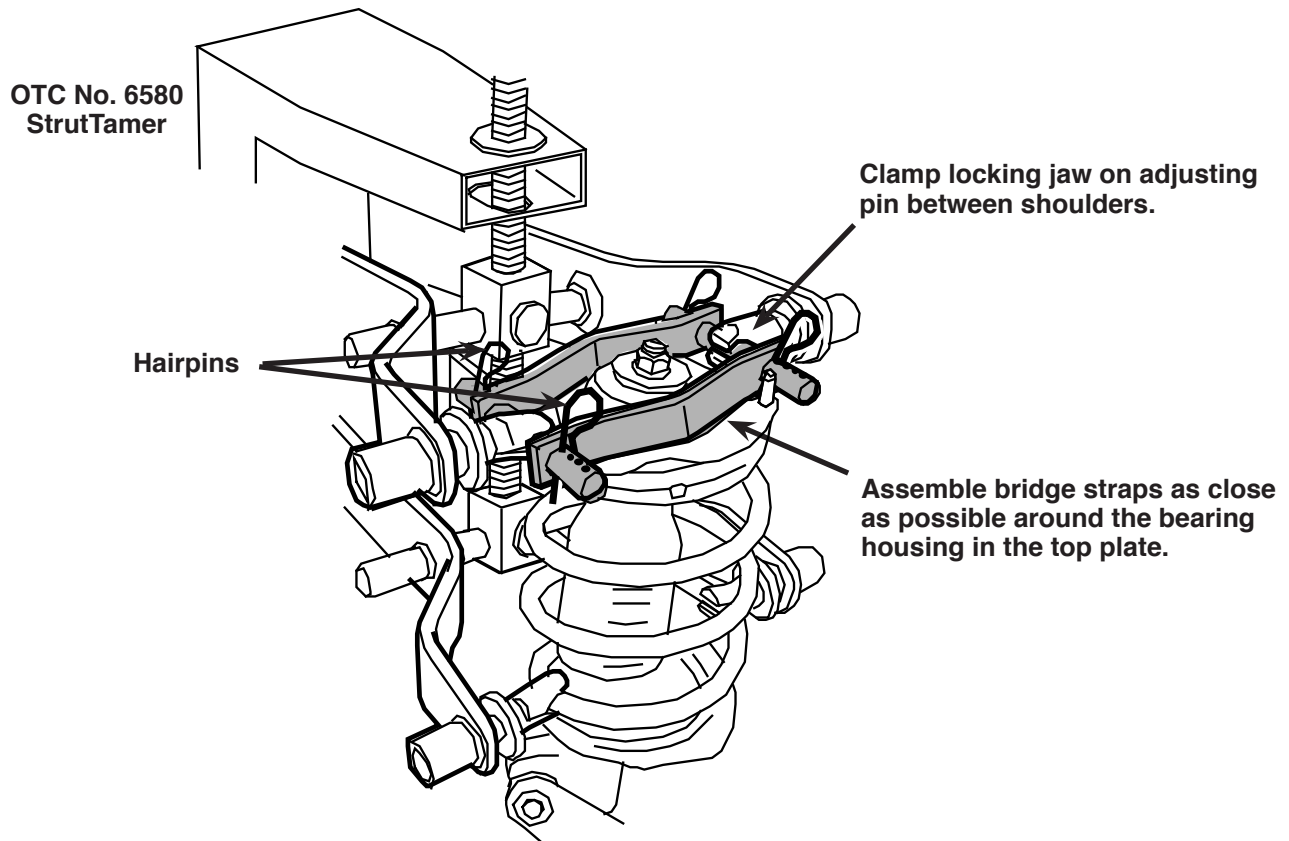

5. Before compressing the spring, refer to the StrutTamer instructions and adjust the StrutTamer so the strut top plate is as parallel to the floor as possible.
6. Turn the StrutTamer forcing screw to compress the spring only until the spring is loose in the spring mount.

⚠ WARNING: Compressing the spring too far will cause premature tool failure that can result in severe personal injury. Compress the spring only until it is loose in the spring mount.

7. Remove the piston rod nut and service the strut as necessary.