



655 Eisenhower Drive
 Owatonna, MN 55060 USA
 Phone: (507) 455-7000
 Tech. Serv.: (800) 533-6127
 Fax: (800) 955-8329
 Order Entry: (800) 533-6127
 Fax: (800) 283-8665
 International Sales: (507) 455-7223
 Fax: (507) 455-7063

Form No. 555231

Parts List &
 Operating Instructions for:

6591

StrutTamer™ Extreme

Parts List

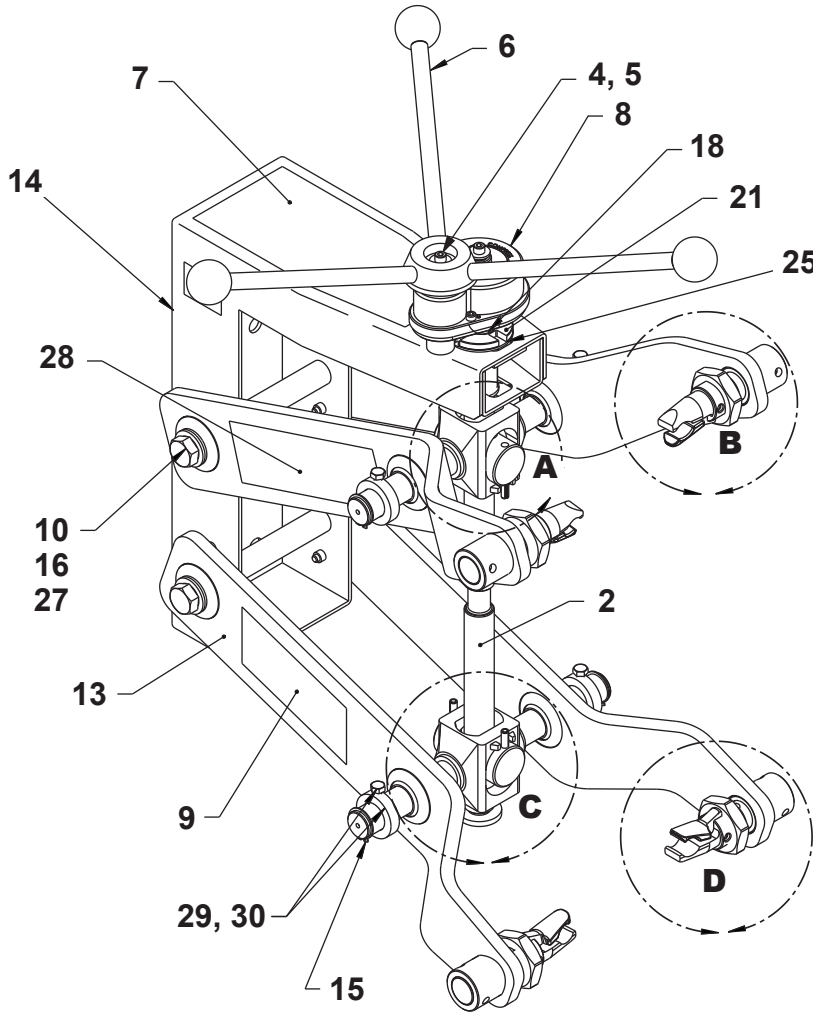

Item No.	Part No.	Qty.	Description
1	519937	2	Universal Trunnion
2	545309	1	Forcing Screw
3	10585	8	Roll Pin (1")
4	16450	1	Washer
5	10807	11	Socket Hd. Cap Screw
6	534688	1	Handle
7	545274	1	Caution Decal
8	6587	1	Gear Box
9	545270	2	Instruction Decal
10	545287	2	Bolt (5/8-11 x 8.50)
11	518443	1	Bottom Trunnion
12	518451	1	Top Trunnion
13	533880	4	Arm
14	545543	1	Body
15	11998	4	Retaining Ring
16	216432	2	Nut
17	15953	1	Washer
18	512037	2	Retaining Ring
19	10982	4	Roll Pin
20	544324	4	Locking Foot
21	534689	1	Bushing
22	519945	4	Locknut
23	544323	4	Support Foot
25	534686	1	Nylon Washer
26	534687	1	Stop Washer
27	13324	4	Washer
28	550814	2	Decal
29	551413	4	Retaining Collar
30	109556	4	Hex Hd. Cap Screw

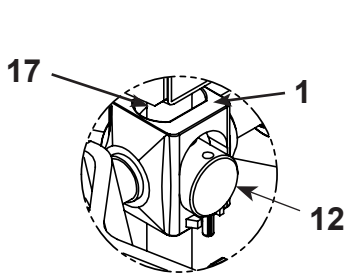

Detail A

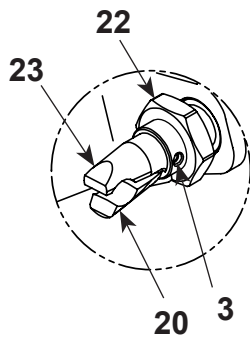

Detail B

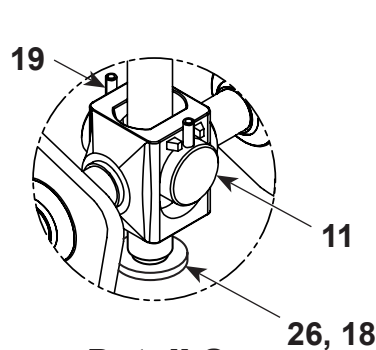

Detail C

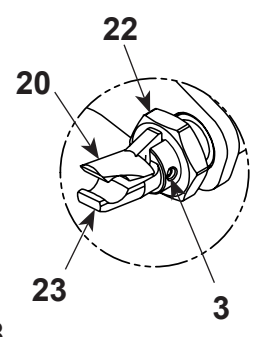

Detail D



Safety Precautions

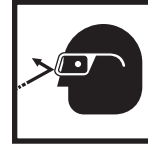

Warning: Spring compression creates a potentially dangerous situation because of the energy stored between the spring mounts. Failure to correctly position the strut assembly in the tool could result in serious injury from a sudden release of strut assembly parts. To prevent personal injury,

- Study, understand, and follow the safety precautions and operating instructions included with the strut spring compressor. If the operator cannot read these instructions, operating instructions and safety precautions must be read and discussed in the operator's native language.
- Wear eye protection that meets ANSI Z87.1 and OSHA standards.
- Use this equipment for automotive strut springs only.
- Check the condition of the strut spring compressor before each use; do not use the equipment if it is damaged, worn, or modified.
- Align the strut assembly before compressing. The spring should be parallel to the forcing screw and on the centerline of the foot support.
- Release and reposition the strut assembly if it is difficult to compress the spring, or if the spring bows.
- Compress the spring only until it is loose in its spring mounts. Stop compressing if the spring or the arms bottom out.
- Do not remove the piston rod nut until the spring is compressed enough to be loose in the mount.

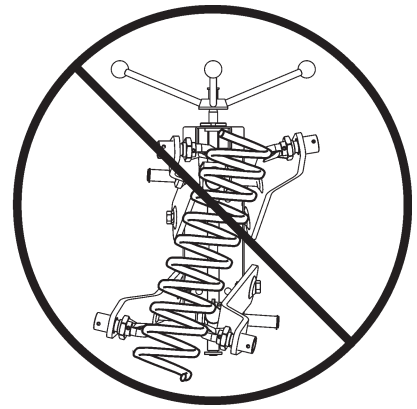

Assembly

The strut spring compressor may be mounted on a wall, or on an optional mobile stand (part no. 6582).

Use the top two holes in the strut spring compressor body to mount the compressor on the No. 6582 optional stand as shown. (Hardware is included with the stand.)

Use all four holes on the back of the strut spring compressor body to mount the compressor to a wall.

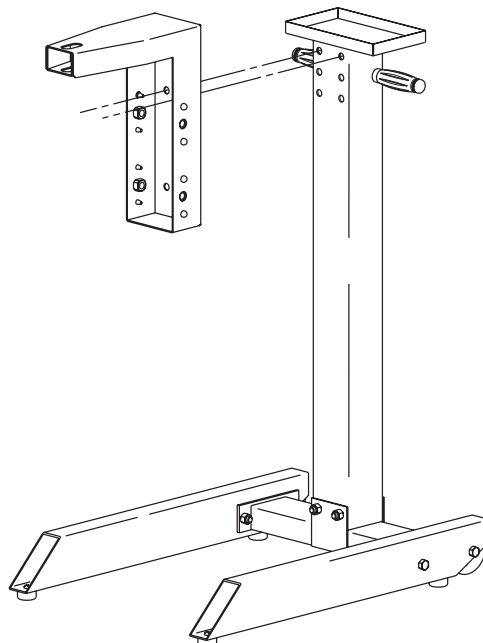

Operating Instructions

Removal

1. Refer to the vehicle service manual, and follow the manufacturer's recommended procedure to remove the strut assembly from the vehicle.
2. Mark the position of the spring in relation to the lower platform and top mount; this notes the correct position for installation.
3. Choose the lowest possible spring coil to insert into the lower left jaw; hand tighten the locknut. See Fig. 1.
4. Load the opposite side of the same coil in the lower right jaw; hand tighten the locknut. *Note: It may be necessary to move the compressor arms to access the coil.*
5. Choose the highest possible spring coil to insert into the upper left jaw; hand tighten the locknut.
6. Load the opposite side of the same coil in the upper right jaw; hand tighten the locknut.

Note: The bridge accessory is designed to be used with the strut spring compressor on strut springs that cannot be compressed enough to remove the retaining nut. Refer to the instructions on the next page.

7. Before servicing the strut assembly, **align the strut spring with the forcing screw** on the strut spring compressor as shown in Figure 1.

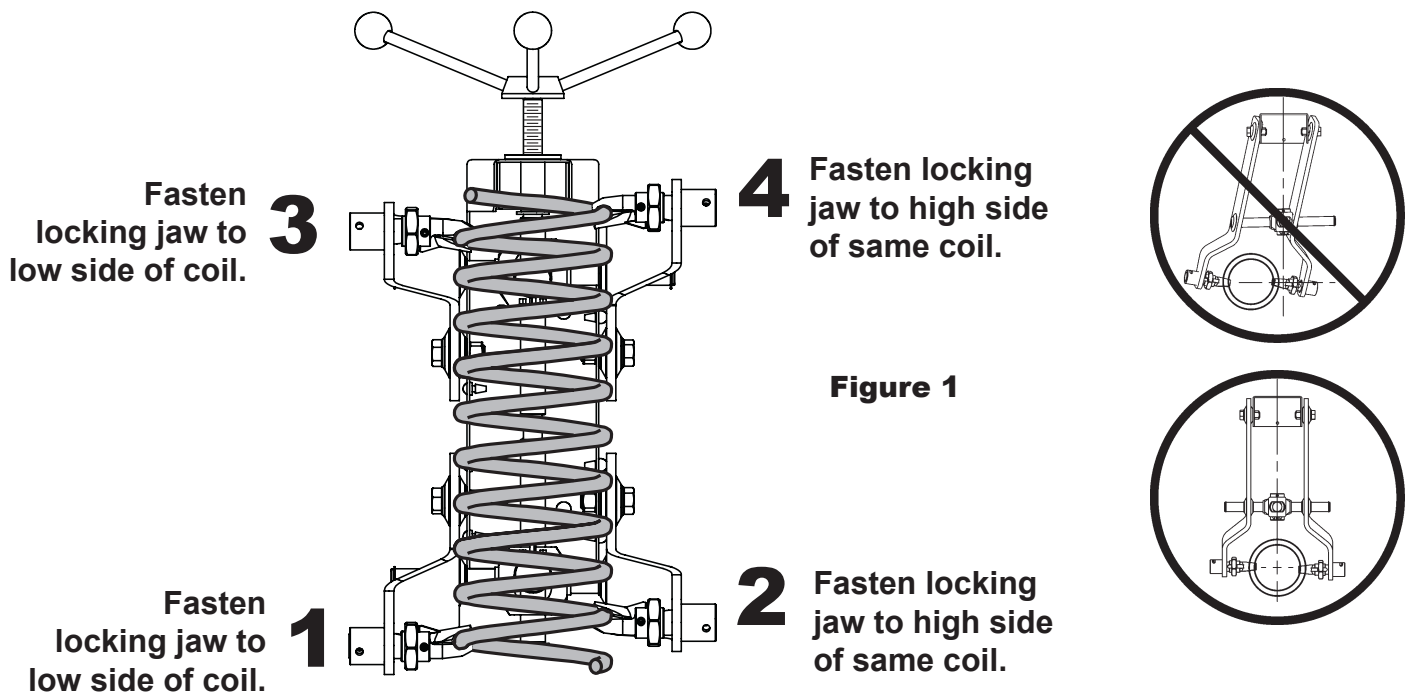

Figure 1

8. Equally space the top arms on the top trunnion as shown in Fig. 2. The forcing screw must be centered between the two top arms.
9. Operate the actuating screw to compress the spring only until the strut cartridge is loose in the spring mounts. **IMPORTANT: It is not necessary to over-compress the spring. The spring should be compressed only until the strut tube is loose in the spring.**
10. Remove the piston rod nut, and service the strut as required.

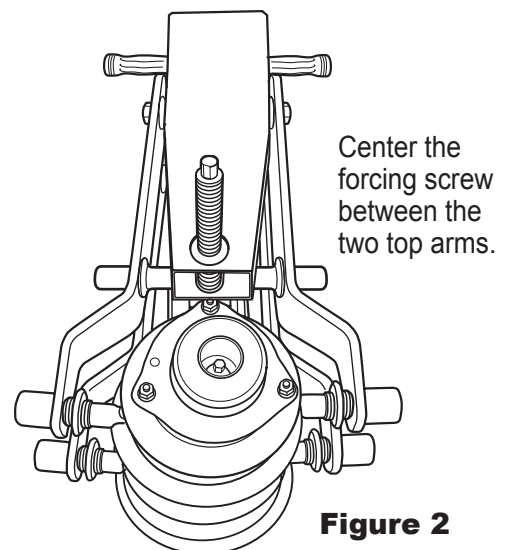

Figure 2

Installation of a New Spring

1. If replacing the spring, remove the old spring from the strut tool. Install the new spring in the tool, assembling the locking jaws as shown in Figure 1. Compress the spring.
2. Align the lower spring tip in its receptacle in the lower platform. Replace the top mount. Attach the piston rod nut, and torque it to the specifications listed in the vehicle service manual.
3. Check the alignment of both spring coil tips to the mounting platforms. Decompress the spring.
4. Follow the manufacturer's procedure to reinstall the strut assembly.

Tech Tip

The top trunnion has been designed as an indicator of spring compression. When the top trunnion is centered as shown in Figure 3, the tool is not applying any force to the strut assembly.

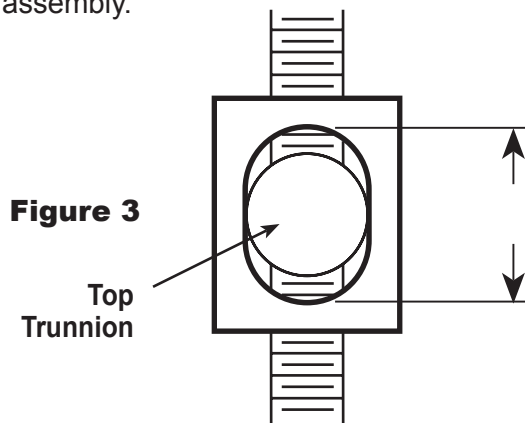

Maintenance

Item numbers refer to the parts list.

1. Use vehicle chassis grease to keep the forcing screw lubricated.

Reassembly Procedure

Follow this procedure if it is necessary to remove the forcing screw (Item No. 2), top trunnion (No. 12), or the bottom trunnion (No. 11) for repair or replacement.

1. Ensure the trunnions (Item Nos. 11 and 12) are driven in approximately one inch from the edge of the forcing screw's bottom threads and one inch from the edge of the top threads, respectively, before remounting the arms onto the trunnions. See Figure 4.

